

VanMove

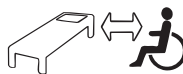

Max: 170 kg/375 lbs

VanMove is an active transfer and transport aid, designed for users with poor balance and reduced lower limb strength. User will need a degree of arm strength and standing function in order to actively participate in the transfer. VanMove is an ideal aid for users who can raise themselves to an upright position to be transferred. VanMove can also be used as a turning device to transfer the user from bed to chair or similar.

Xa T [^ is part of a series of different models of transfer assistive devices. The choice of assistive devices depends on the transfer situation and the patient's functional capability and needs.



Functional inspection

Visual inspection

Check the condition and function of the assistive device regularly. Check to ensure that seams and material are free from damage. If there are signs of wear, the product must be inspected and serviced.



Always read the manual

Always read the manuals for all assistive devices used during a transfer.

Keep the manual where it is accessible to users of the product.

Do not leave the patient unattended during a transfer situation.

The product should be inspected yearly, and otherwise as required, by a qualified technician. Service must be performed by a qualified technician.

Description of parts



1. Seat support
2. Depth adjustable kneepad
3. Reglage för vinkling av säte
4. Manual adjustment of seat depth
5. Height adjustable kneepad
6. Footpedal for leg spread adjustment
7. 2 x rear braked castors
8. Detachable footplate

Functions



- **Split seat pads:** both swing away and flip-up. (picture 1).
- **Knee pad:** depth and height adjustable and tiltable.
- **Foot pedal:** for adjusting leg spread in and out.
- **Angle adjustment crossbar:** adjusts seat and handgrip angle up or down to optimise seating comfort and positioning of user. (picture 2).
- **Seat depth:** two positions, manually adjustable.
- **Footplate:** covered with non-slip surface, detachable.



Special requirements and conditions

- VanMove is not intended for long transfers.
- VanMove can only be used on a flat floor.

To transfer with VanMove, the patient must be able to:

- support weight while standing
- stand up and maintain balance (with support)
- grasp handles
- understand instructions

Testing standing function

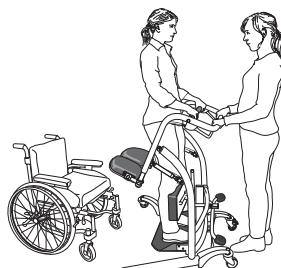

VanMove is ideal for testing a patient's standing function in cases where there is uncertainty as to whether the patient is able to rise from a seated to a standing position.

Training standing function

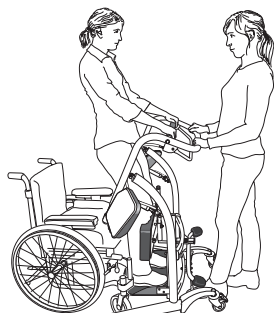

VanMove can be used to train the patient's standing, sitting, and sit-to-stand function. To measure improvement, use a stopwatch or clock with a second hand to time the patient.

Farther back in the chair

If the patient slides forward in the wheelchair, the VanMove can be used to help the patient to slide farther back in the chair

Remove/raise the wheelchair foot plates, and then run the VanMove in towards the wheelchair. The patient places his/her feet on the foot plate, grasps the raising ladder, leans forward, and then lifts from the seat. The caregiver provides counter pressure. Slide the patient farther back in the chair when he/she has lifted slightly from the seat.

Using VanMove

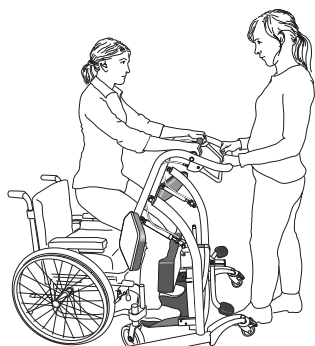

Place the VanMove as close to the patient as possible and ask the patient to place his or her feet on the footrest. Adjust both the height and depth of the leg supports, as well as the seat depth, if necessary.

The patient can then grasp the soft handlebar and rise to a standing position.

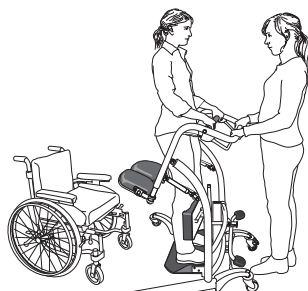

When the patient has risen to a standing position, the caregiver lowers the seat behind the patient.

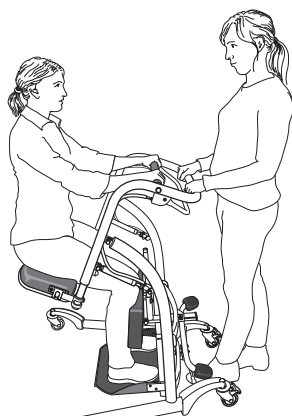

The patient will then be able to sit during transfer. For optimal sitting comfort, the caregiver can regulate the angle of the seat using the adjustment bar on the handlebar. This function also facilitates standing, since the sitting height is higher and the patient's legs are straighter.

Technical information

A Length	900-1030 mm	35.4 – 40.5"
B Width, inner. Min. leg spread. Castor to castor.	455 mm	17.9"
C Width, inner. Max. leg spread. Castor to castor.	830 mm	32.6"
D Width, outer. Min. leg spread. Castor to castor.	615 mm	24.2"
E Width, outer. Max. leg spread. Castor to castor.	1050 mm	41.3"
F Width between legs. Min. leg spread.	480 mm	18.8"
G Width between legs. Max. leg spread.	620 mm	24.4"
H Height adjustment: Floor to pushbar	1065 – 1120 mm	41.9 – 44"
I Height: Floor top of castor frame	140 mm	5.5"
J Height: Floor top of leg	45 mm	1.7"
K Seat height: Min.	730 mm	28.7"
L Seat height: Max.	850 mm	33.4"
Seat width:	480 mm	18.8"
Seat depth:	265 mm	10.4"
Castor Ø	Ø80 mm	Ø3"
Weight:	35 kg	77 lbs
Max. weight capacity:	170 kg	375 lbs

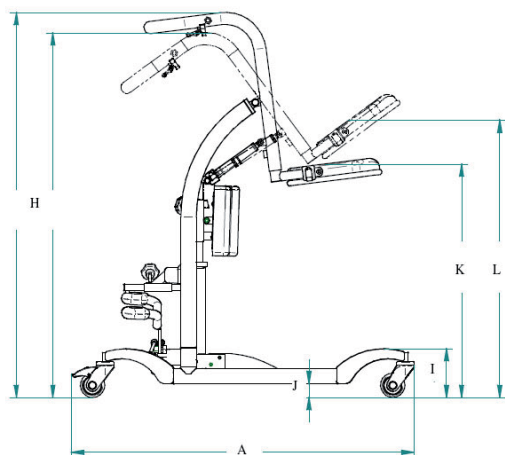
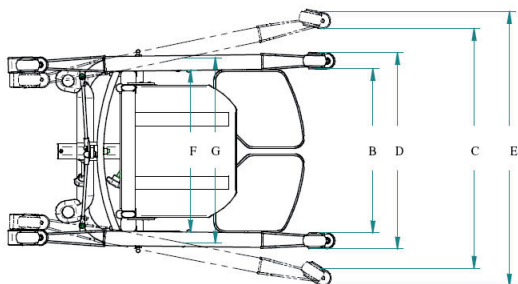

Care of the product

- Use a soft cloth and mild cleaning agent such as dishwashing liquid or car shampoo to clean the VanMove. Do not use abrasive cloths or brushes.
- Do not use solvents.
- To disinfect, use 70% alcohol.

Optional support belts to be used with the the VanMove belts are Vanturn belts:

Small 4-206033
Medium 4-206034
Large 4-206035
X-Large 4-206036

Patient Specific/Disposables are available in cases of 10 only.



Contact your local distributor if you have any questions about the product and its use. See www.vancare.com for a complete list of distributors. Always make sure that you have the current version of the manual. The most recent editions of manuals are available for downloading from our website, www.vancare.com.

Manufactured for:

Vancare, Inc.
1515 First St
Aurora, NE 68818

(800) 694-4525
info@vancare.com



VanMove Stand Aid

Competency Assessment

Competency Statement: After attending this orientation, the clinician will be able to properly use specialty equipment according to manufacturer's recommendations. If the performance criteria are not met, additional training will be provided. If the caregiver has any questions always consult the product owner manual prior to use or contact your Vancare Representative.

Directions: Check the appropriate box for each performance criteria. Schedule retraining as indicated.

ALWAYS EXPLAIN PROCEDURE TO RESIDENT OR PATIENT BEFORE AND DURING TASK.	Verbalized understanding	Performed	Needs review
Describe and demonstrate equipment features			
Safety checks <ul style="list-style-type: none"> Person weight being lifted appropriate for product limits Shin bolster centered and feet on foot plate Patient meets physical and cognitive guidelines 			
Patient physical and cognitive guidelines			
1. Patient able to weightbear to actively participate in standing position			
2. Patient is aware of surrounding and able to follow directions.			
3. Patient is not combative or agitated			
Operation of VanMove Stand Aid (374 lbs max.)			
1. Position VanMove at bed or chair using leg spreader open and close base prior to placing patient's feet on foot plate.			
2. Adjust shin bolster just below knee to allow the patient's knees to bend			
3. Open and adjust seat swing pads to allow patient to stand and close seat swing pads for safety and sitting when necessary			
4. Adjust tilt handle bar mechanism to assist patient to stand and return to sitting position			
5. Lock and unlock casters. Following adjustment of shin bolsters, lock rear casters prior to standing patient			
6. Unlock casters once patient is secure and caregiver is ready to move patient.			
7. When moving patient on VanMove through door thresholds back over all raised barriers			
8. Observe and verbalize understanding of transfer from chair, bed, commode/toilet			
9. Demonstrate proper body mechanics when moving VanMove with patient. Explain significance of ergonomic design			
10. Caregiver verbalizes knowledge of where VanMove product owner manuals are kept			

I understand how to use the equipment and all of my questions have been answered. If I have any questions prior to use of transfer device I will consult the owner/use manual for the VanMove Sit-to-Stand.

Name: _____ **Title** _____ **Signature** _____

Evaluator Signature: _____ **Date:** _____